

UBOX RSH ja RSV

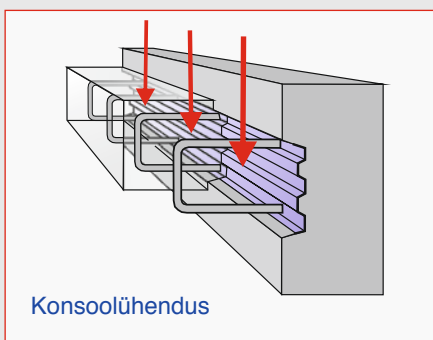
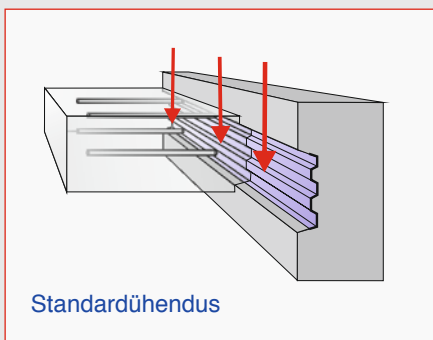
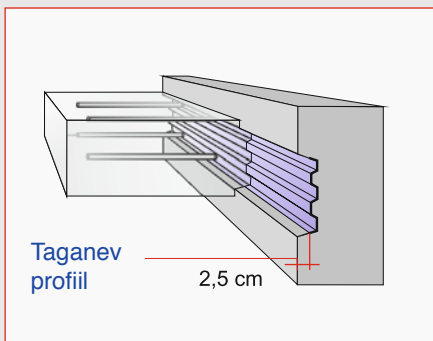

Ubox - ankurduselementi kasutatakse raudbetoonkonstruktsioonides armatuuri ühendamisel teiste elementidega erinevate nurkade all, st seinad vahelagedega. Näiteks seinad vahelagedega, seinad trepimademetega, seinad seintega jne.

Ubox ankurduselementide tüübid:

- Ubox RSH - kaherealine
- Ubox RSV - üherealine
- Ubox RSH **aktiv** - tihendiga
- Ubox RSH, tüüp S - mittestandardne

Tehniline tunnustus AT-15-6287/2009

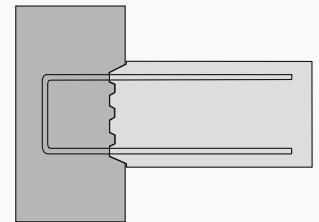

Kasutuskeem

Mõõtmed ja paigaldus

Ubox RSH - hammasprofiil vastab kõigile Eurocode 2 nõuetele.

Arvutused – vaata eespool

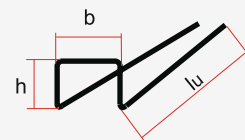
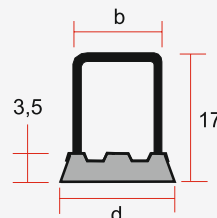

Ubox RSV - sile kategooria

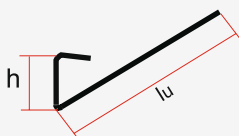

Sarruseteras: BST 500
Terase läbimõõt: 8–12 mm

Paigaldus:

1. Ubox RSH kinnitada raketise külge. Ubox RSH aasad ühendada armatuuriga. Peale raketise sulgemist betoneerida.



2. Eemaldada raketis, avada Ubox RSH tagumine sein ja võtta painutatud armatuurvardad lahti.

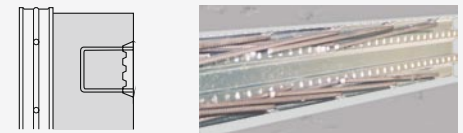

3. Ubox RSH elemendi tagaseina all olevad armatuurvardad painutada sirgeks ja ühendada järgneva elemendiga.



NB! Vardaid tohib sirgeks painutada vaid ühe korra.

Ankurduselementide võrdlus

Ankurduselementi survetugevuse kvaliteedivõrdlus sõltuvalt vuugi liigist.

Ubox RSH talub suuremaid koormusi. Ubox RSH vähendab kulusid.

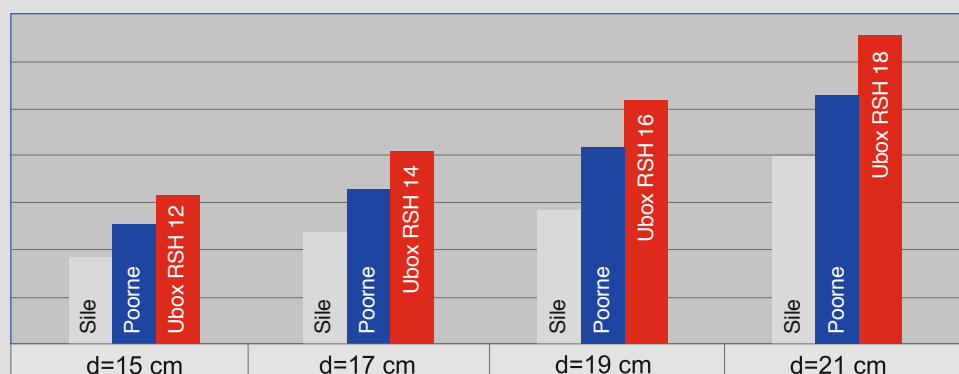

Ubox RSV tehnilised andmed

a - (armatuuri samm)

Toote number	Tüüp	Terase läbimõõt, mm	a, cm	b, cm	L, m	lu, cm
507-0815	RSV 8-15	8	15	17	1,25	30
507-0820	RSV 8-20	8	20	17	1,25	30
507-1015	RSV 10-15	10	15	17	1,25	38
507-1020	RSV 10-20	10	20	17	1,25	38
507-1215	RSV 12-15	12	15	17	1,25	45
507-1220	RSV 12-20	12	20	17	1,25	45

Ubox RSH tehnilised andmed

Toote number	Tüüp	b, cm	Terase Ø, mm	a, cm	h, cm	d, cm	L, m	lu, cm
508-0815	RSH 8-8-15	8	8	15	17	11	1,25	30
508-0820	RSH 8-8-20	8	8	20	17	11	1,25	30
508-1015	RSH 8-10-15	8	10	15	17	11	1,25	38
508-1020	RSH 8-10-20	8	10	20	17	11	1,25	38
591-0815	RSH 11-8-15	11	8	15	17	14	1,25	30
591-0820	RSH 11-8-20	11	8	20	17	14	1,25	30
591-1015	RSH 11-10-15	11	10	15	17	14	1,25	38
591-1020	RSH 11-10-20	11	10	20	17	14	1,25	38
591-1215	RSH 11-12-15	11	12	15	17	14	1,25	45
591-1220	RSH 11-12-20	11	12	20	17	14	1,25	45
592-0815	RSH 12-8-15	12	8	15	17	15	1,25	30
592-0820	RSH 12-8-20	12	8	20	17	15	1,25	30
592-1015	RSH 12-10-15	12	10	15	17	15	1,25	38
592-1020	RSH 12-10-20	12	10	20	17	15	1,25	38
592-1215	RSH 12-12-15	12	12	15	17	15	1,25	45
592-1220	RSH 12-12-20	12	12	20	17	15	1,25	45
594-0815	RSH 14-8-15	14	8	15	17	17	1,25	30
594-0820	RSH 14-8-20	14	8	20	17	17	1,25	30
594-1015	RSH 14-10-15	14	10	15	17	17	1,25	38
594-1020	RSH 14-10-20	14	10	20	17	17	1,25	38
594-1215	RSH 14-12-15	14	12	15	17	17	1,25	45
594-1220	RSH 14-12-20	14	12	20	17	17	1,25	45
596-0815	RSH 16-8-15	16	8	15	17	19	1,25	30
596-0820	RSH 16-8-20	16	8	20	17	19	1,25	30
596-1015	RSH 16-10-15	16	10	15	17	19	1,25	38
596-1020	RSH 16-10-20	16	10	20	17	19	1,25	38
596-1215	RSH 16-12-15	16	12	15	17	19	1,25	45
596-1220	RSH 16-12-20	16	12	20	17	19	1,25	45
598-0815	RSH 18-8-15	18	8	15	17	21	1,25	30
598-0820	RSH 18-8-20	18	8	20	17	21	1,25	30
598-1015	RSH 18-10-15	18	10	15	17	21	1,25	38
598-1020	RSH 18-10-20	18	10	20	17	21	1,25	38
598-1215	RSH 18-12-15	18	12	15	17	21	1,25	45
598-1220	RSH 18-12-20	18	12	20	17	21	1,25	45
590-0815	RSH 20-8-15	20	8	15	17	23	1,25	30
590-0820	RSH 20-8-20	20	8	20	17	23	1,25	30
590-1015	RSH 20-10-15	20	10	15	17	23	1,25	38
590-1020	RSH 20-10-20	20	10	20	17	23	1,25	38
590-1215	RSH 20-12-15	20	12	15	17	23	1,25	45
590-1220	RSH 20-12-20	20	12	20	17	23	1,25	45
599-0815	RSH 22-8-15	22	8	15	17	25	1,25	30
599-0820	RSH 22-8-20	22	8	20	17	25	1,25	30
599-1015	RSH 22-10-15	22	10	15	17	25	1,25	38
599-1020	RSH 22-10-20	22	10	20	17	25	1,25	38
599-1215	RSH 22-12-15	22	12	15	17	25	1,25	45
599-1220	RSH 22-12-20	22	12	20	17	25	1,25	45

